

**Important Safety Instructions**

1. Please do not place device near any form of heat sources.
2. Please use the accessories specified by the manufacturer.
3. Please refer all servicing/repairs to a qualified personnel should there be any form of damage to the device.
4. Keep this user manual for future referencing/troubleshooting.
5. Please heed ALL safety cautions.

**Safety Cautions**

1. Always keep device AWAY from fire and heat sources.
2. Do NOT attempt to disassemble or alter the device.
3. Do NOT expose device to excessive heat (Direct sunlight etc.).
4. Do NOT immerse device into any form of liquids.

**Unboxing**



- RS-X60 Diviner Speaker
- Charging Adaptor
- Remote Control

Please refrain from using any damaged components. Contact your local authorized AIWA distributor/customer service should you need any assistance.

**Product Specifications**

Model Number: RS-X60 Diviner Ace  
 BT Version: V5.0  
 Power Output: 60W  
 Impedance: 4Ω  
 Frequency Response: 60Hz - 23KHz  
 S/N Ratio: ≥ 80dB  
 Sensitivity: 400mV  
 Supports: BT, AUX, TF Card, USB, TWS  
 Supported Profiles: MP3, WMA, WAV, FLAC  
 Transmission Distance (Estimated): 10 Meters (No Obstacles)  
 DC Input Voltage/Current: 9V DC, 1A/2A  
 Battery: 7.4V/ 6000mAh  
 Playback Time: 4 - 5 Hours  
 Charging Time: 4 - 5 Hours  
 Dimensions: 350\*185\*195mm  
 Weight: 4.3 Kg

The above playback & charging times are estimated values tested in a practical environment and may vary upon individual usage habits.

**Product Overview**

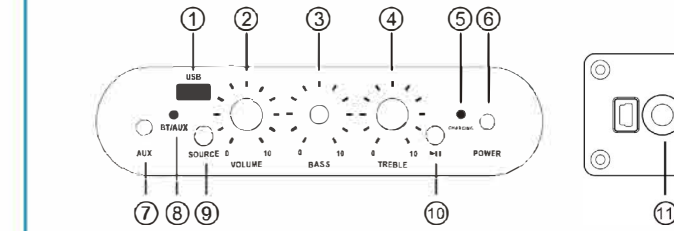

1. USB Port
2. Master Volume Knob
3. Bass Adjustment Knob
4. Treble Adjustment Knob
5. Charging Indicator Light (Red while Charging, Green when Full Battery)
6. Power ON/OFF
7. AUX-In
8. BT/AUX Indicator Light
9. Source Button
10. Play/Pause Button
11. Charging Port 9V

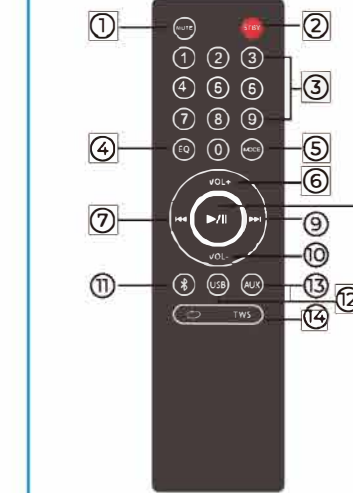

1. Mute
2. Standby Mode
3. 0-9 Number Keys
4. EQ Cycle between Sound Profiles: Classic/ Rock & Roll/Jazz
5. Mode Cycle between Audio Modes: BT/USB/AUX
6. Volume +
7. Previous Track
8. Play/Pause
9. Next Track
10. Volume -
11. BT Mode
12. USB Mode
13. AUX Mode
14. TWS Connection Button

**Playback Sources**

**USB Playback:** Insert USB into the designated port, playback will commence upon pressing play/pause button.  
**AUX Playback:** Disconnect all BT devices before inserting AUX cable and connect it to audio source to start.

**Connecting the Product**

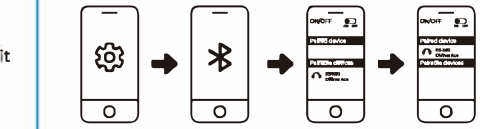

1. Turn on Bluetooth (BT) on your mobile device.
2. Turn on the speaker.
3. Search and connect to "RS-X60 Diviner Ace" from your mobile device.
4. Press and hold Play/Pause button for 3-4 seconds to disconnect.

**TWS Function**

1. Turn on both speakers (Only compatible with the same model).

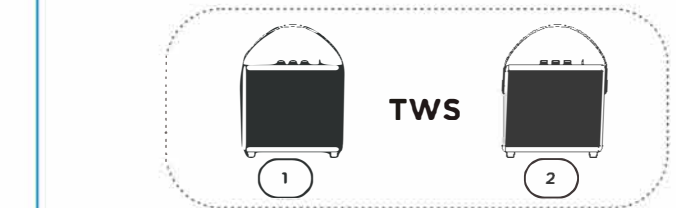

**Battery & Charging**

**Charging the speaker:**

Connect charging adaptor to the speaker and a suitable power source



Approximate charging time: 4-5Hours  
 Please fully charge up the speaker prior to first-time usage.

**Troubleshooting**

**Unable to connect to device:**

1. Please ensure the speaker is not connected to other devices
2. Please ensure the speaker is within 10m from the device

**No sound is coming out of the speaker:**

1. Please ensure your device is connected to the speaker.
2. Please ensure the music volume is at an audible level on both your mobile device and speaker.



Aiwa Electronics Int'l Co., Ltd.  
 Explore more at [www.int-aiwa.com](http://www.int-aiwa.com)