

AT-X80A

True Wireless Earphones

Designed in Japan
アイワ株式会社

Product Overview

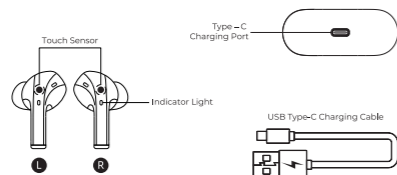

Unboxing

- AT-X80A Earbuds
- Portable Charging Case
- USB Type-C Charging Cable
- Silicone Ear-tips (L & S Size)
- User's Manual

Please refrain from using any damaged components. Contact your local authorized AIWA distributor/customer service should you need any assistance.

Product Specifications

Model Number: AT-X80A
BT Version: V5.1
IP Rating: IPX4
Rated Power: 5mW
Frequency Response: 20~20kHz
Impedance: 16Ω ± 15%
Sensitivity: 103dB ± 3dB
Supported Profiles: HFP/A2DP/AVRCP
Transmission Distance (Estimated): 10 Meters (No Obstacles)
Battery (Earbuds): 3.7V/40mAh
Battery (Charging Case): 3.7V/400mAh
Playback/ Call Time: 4-5 Hours
Earbuds Standby Time: 50 Hours
Charging Case Standby Time: 200 Days
Charging Time (Portable Case): 1.5 Hours
Charging Time (Earbuds): 1.5 Hours
Charging Time (Portable Case with Earbuds): 3.5 Hours
Earbuds Weight: 3.5g each
Charging Case Weight: 35g

The above are estimated values tested in a practical environment and may vary upon individual usage habits. Charging case holds approximately 2-3 charges of earbud's full battery capacity depending on playback volume.

Product Usage Guide



Manual ON/OFF:

Manual ON: Long press touch sensor for two (2) seconds
Alternate flashing orange & green indicator light.
*Make sure earphones are fully charged before using them for the first time.

Manual OFF: Long press touch sensor for four (4) seconds
Orange indicator light lights up and extinguishes.
*AT-X80A automatically powers off after 5 minutes of disconnection.

Music Control:

Play/Pause: Click touch sensor once (1)
Next Song: Click touch sensor twice (2)
Previous Song: Click touch sensor thrice (3)

Call Control:

Answer/Hang Up: Click touch sensor once (1)
Reject Call: Long press touch sensor for one and a half (1.5) seconds

Voice Assistant:

Activate Voice Assistant: Long press touch sensor for one and a half (1.5) seconds

Connecting the Product

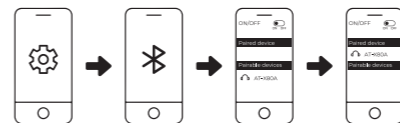

1. Turn on Bluetooth (BT) on your mobile device
2. Turn on Earbuds (Flipping open charging case will power up earbuds)
3. Search and connect to "AT-X80A" from your mobile device

Troubleshooting

L side earbud cannot be linked with R side earbud
Solution: Place earbuds back into charging case and close the case. Re-open the lid after a few seconds. The earbuds would now be linked to each other & ready to be connected to your mobile device.

Only one (1) side earbud can be linked to your device
Solution: Ensure both earbuds are ON and disconnected from any devices. Click both touch sensors four (4) times, then place earbuds back into charging case. AT-X80A will be ready to connect once you remove them from the charging case.

Battery & Charging

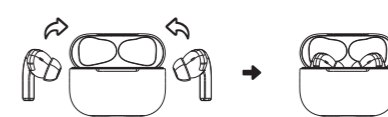

Charging Earbuds (Place them back into charging case):

- Charging:*Orange Indicator Light*
- Full Charge:*Extinguished Indicator Light*
- Approximate charging time: 1.5 Hours



Charging the Portable Charging Case (Plug in USB - C Charging Cable):

- Charging:*Digital Display flashes*
- Full Charge:*Digital Display remains lit up*
- Approximate charging time: 1.5 Hours